

BATTERY MAINTENANCE PRODUCTS



BATTERY TERMINALS
BATTERY DISTRIBUTION TERMINALS
BATTERY STARTER CABLES
BATTERY STARTER TERMINALS
BATTERY STRAIGHT CLAMP CABLES
BATTERY ISOLATOR
BATTERY SURGE PROTECTORS



Isolating Master Terminal

Part No	Pack Type	Terminal Type	Post Type	Suits Cable Size	Stud Size
812110	Blister - 1		Negative		



Lead Terminal

Part No	Pack Type	Terminal Type	Post Type	Suits Cable Size	Stud Size
812111	Blister - 2	Saddle	Universal	8-50mm ² (8-0B&S)	
812112	Blister - 2	Saddle	Universal		5/16" 8mm ²



Solder/Crimp Battery Terminal

Part No	Pack Type	Terminal Type	Post Type	Suits Cable Size	Stud Size
812113	Blister - 1	Split Barrel	Universal	50-70mm ² (0-00 B&S)	-
812114	Box - 10				
812115	Blister - 1	Split Barrel	Universal	23-35mm ² (3-2 B&S)	-
812116	Box - 10				



Brass Battery Terminal

Part No	Pack Type	Terminal Type	Post Type	Suits Cable Size	Stud Size
812117	Blister - 1	Saddle	Universal	8-50mm ² (8-0B&S)	-
812118	Box - 10				
812119	Blister - 1	Heavy Duty Saddle	Universal	50-95mm ² (0-000B&S)	-
812120	Box - 10				
812121	Blister - 1	Suits Small Japanese Battery Post	Positive	8-35mm ² (8-2B&S)	-
812122	Box - 10				
812123	Blister - 1	Suits Small Japanese Battery Post	Negative	8-35mm ² (8-2B&S)	-
812124	Box - 10				
812125	Blister - 1	Single Bolt Side Entry	Universal	8-35mm ² (8-0B&S)	-
812126	Box - 10				
812127	Blister - 1	End Entry	Universal	15-50mm ² (6-0B&S)	-
812128	Box - 10				
812129	Blister - 1	Heavy Duty End Entry	Universal	15-70mm ² (6-00B&S)	-
812130	Box - 10				



812131	Blister - 1	Wignut Type	Positive	-	5/16" (6mm)
812132	Box - 10				
812133	Blister - 1	Wignut Type	Negative	-	5/16" (6mm)
812134	Box - 10				
812135	Blister - 1	Heavy Duty Wignut	Positive	-	3/8" (10mm)
812136	Box - 10				
812137	Blister - 1	Heavy Duty Wignut	Negative	-	3/8" (10mm)
812138	Box - 10				
812139	Blister - 1	Crimp End Entry	Universal	26-50mm ² (3-0B&S)	-
812140	Box - 10				
812141	Blister - 1	Crimp End Entry	Universal	15-70mm ² (2-00B&S)	-
812142	Box - 10				
812143	Blister - 1	Bolt	Positive	-	5/16" (8mm)
812144	Box - 10				
812145	Blister - 1	Bolt	Negative	-	5/16" (8mm)
812146	Box - 10				
812147	Blister - 1	Heavy Duty Bolt	Positive	-	3/8" (10mm)
812148	Box - 10				
812149	Blister - 1	Heavy Duty Bolt	Negative	-	3/8" (10mm)
812150	Box - 10				

Forged Brass Battery Terminal

Part No	Pack Type	Terminal Type	Post Type	Suits Cable Size	Stud Size
812167	Blister - 1	Wignut	Positive	-	5/16" (8mm)
812168	Box - 10				
812169	Blister - 1	Wignut	Negative	-	5/16" (8mm)
812170	Box - 10				
812171	Blister - 1	Heavy Duty Wignut	Positive	-	3/8" (10mm)
812172	Box - 10				
812173	Blister - 1	Heavy Duty Wignut	Negative	-	3/8" (10mm)
812174	Box - 10				





Forged Brass Battery Terminal

Part No	Pack Type	Terminal Type	Post Type	Suits Cable Size	Stud Size
812175	Blister - 1	Bolt	Positive	8-50mm ² (8-0B&S)	5/16" (8mm)
812176	Box - 10				
812177	Blister - 1	Bolt	Negative	50-95mm ² (8-0B&S)	5/16" (8mm)
812178	Box - 10				
812179	Blister - 1	Heavy Duty Bolt	Positive	-	3/8" (10mm)
812180	Box - 10				
812181	Blister - 1	Heavy Duty Bolt	Negative	-	3/8" (10mm)
812182	Box - 10				
812183	Blister - 1	Saddle with Dual Auxiliary	Positive	20-35mm ² (4-2B&S) Auxiliary 5-15mm ² (10-6B&S)	-
812184	Box - 10				
812185	Blister - 1	Saddle with Dual Auxiliary	Negative	20-35mm ² (4-2B&S) Auxiliary 5-15mm ² (10-6B&S)	-
812186	Box - 10				
812187	Blister - 1	Heavy Duty Saddle with Dual Auxiliary	Positive	50-70mm ² (0-00B&S) Auxiliary 5-15mm ² (10-6B&S)	-
812188	Box - 10				
812189	Blister - 1	Heavy Duty Saddle with Dual Auxiliary	Negative	50-70mm ² (0-00B&S) Auxiliary 5-15mm ² (10-6B&S)	-
812190	Box - 10				

Satin Forged Brass Battery Terminal

Part No	Pack Type	Terminal Type	Post Type	Suits Cable Size	Stud Size
812191	Blister - 1	Saddle	Positive	20-35mm ² (4-2B&S)	-
812192	Box - 10				
812193	Blister - 1	Saddle	Negative	20-35mm ² (4-2B&S)	-
812194	Box - 10				
812195	Blister - 1	Heavy Duty Saddle	Positive	50-70mm ² (0-00B&S)	5/16" (8mm)
812196	Box - 10				
812197	Blister - 1	Heavy Duty Saddle	Negative	50-70mm ² (0-00B&S)	5/16" (8mm)
812198	Box - 10				





812229	Blister - 1	Saddle With Dual Auxiliary	Positive	-	3/8" (10mm)
812230	Box - 10				
812231	Blister - 1	Saddle With Dual Auxiliary	Negative	-	3/8" (10mm)
812232	Box - 10				
812233	Blister - 1	Heavy Duty Saddle with Dual Auxiliary	Positive	-	-
812234	Box - 10				
812235	Blister - 1	Heavy Duty Saddle with Dual Auxiliary	Negative	-	-
812236	Box - 10				

BATTERY DISTRIBUTION TERMINAL

Part No./ Description

812710

Single Distribution Terminal (Red with Cap)

Feature :

TERMINAL TYPE	Crimp
POST TYPE	Positive
CABLE SIZE	23-35mm ² (3-2 B&S)
FULLY INSULATED CAP	Prevents accidental short circuit

812711

Bulk pack of 25

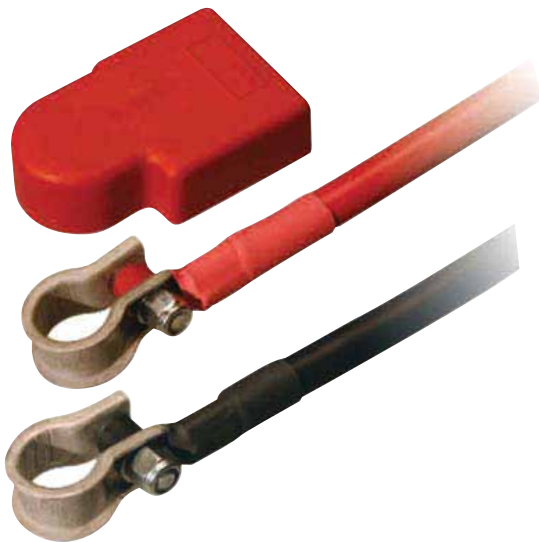

Part No./ Description

812710N

Single Distribution Terminal

Feature :

TERMINAL TYPE	Crimp
POST TYPE	Negative
CABLE SIZE	23-35mm ² (3-2 B&S)

812712

Bulk pack of 25

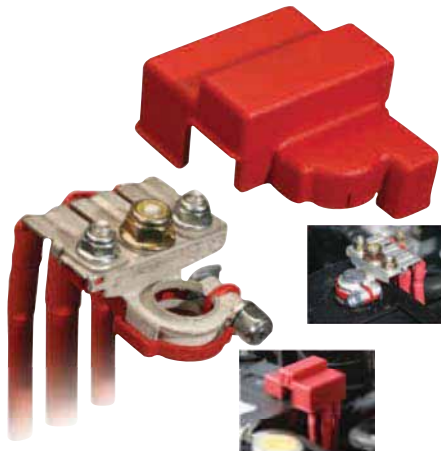

Part No./ Description

812713P

Battery Distribution Terminal

Three way distribution

Quickly converts your battery post so you can easily connect three cables to your battery. Ideal for use when installing auxiliary accessories or connecting to a secondary battery. Includes three terminals to ensure quick connection. Makes a professional and practical installation for distributing power.

Specifications

1 x M8 terminal suits 20-40mm² (4-2 B&S) cable.

2 x M6 terminal suits 8-20mm² (8-4 B&S) cable.

Economical

Save money by using one product that does the same as a battery terminal and terminated cable.

Fully insulated cap

Prevents accidental short circuits.

812713N

Battery Distribution Terminal Negative Black

Replacement to suit 925 terminal distribution box

812714-T1 M6 8-20mm² (8-4B&S)

812714-T2 M8 20-40mm² (4-2B&S)

Part No./ Description

812715P

Battery Distribution Terminal

Three way distribution

Quickly converts your battery post so you can easily connect three cables to your battery. Ideal for use when installing auxiliary accessories or connecting to a secondary battery. Includes three studs (1 x M8, 2 x M5) to ensure quick connection. Makes a professional and practical installation for distributing power.

Specifications

Provides the convenience of having three fused outlets making it safe and easy to install dual battery systems and other auxiliary cables.

Economical

Save money by using one product that does the same as a battery terminal and terminated cable and a fuse box.



BATTERY STARTER CABLE



Part No./ Description

813010

Battery Starter Cable

Features:

- Brass terminal
- Tin-plated copper lug to suit 10mm (3/8") stud
- Annealed copper cable with PVC insulation
- Durable polyolefin heat shrink for lasting protection
- Mechanically crimped to ensure a solid permanent connection

Part No./ Description

813011

Battery Starter / Alternator Cable

Features:

- Brass terminal
- Tin-plated copper lug to suit 10mm (3/8") stud
- Brass ring terminal to suit 6mm (1/4") stud
- Annealed copper cable with PVC insulation
- Durable polyolefin heat shrink for lasting protection
- Terminal ends mechanically crimped to ensure a solid permanent connection



Part No./ Description

813012

Battery Switch Starter Cables

Features:

- Tin-plated copper lug to suit 10mm (3/8") stud
- Annealed copper cable with PVC insulation
- Durable polyolefin heat shrink for lasting protection
- Terminal ends mechanically crimped to ensure a solid permanent connection



Part No./ Description

813013

Battery Joiner Cable

Features:

- Nickel plated brass terminal
- Annealed copper cable with PVC insulation
- Durable polyolefin heat shrink for lasting protection
- Mechanically crimped to ensure a solid permanent connection



BATTERY STRAIGHT CLAMP COVER

Part No./ Description

813210

Terminal Cover Black Straight

Black Straight Clmap Cover with 13mm diameter cable entry. Designed to protect alternator and electrical system from short and reduce battery terminal corrosion. Manufactured from 90° rated, high temperature poly vinyl chloride.

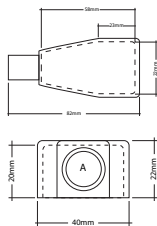

Part No./ Description

813211

Terminal Cover Red Straight

Red Straight Clmap Cover with 13mm diameter cable entry. Designed to protect alternator and electrical system from short and reduce battery terminal corrosion. Manufactured from 90° rated, high temperature poly vinyl chloride.

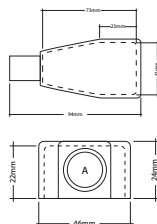



Part No./ Description

813212 Terminal Cover Black Straight

Black Straight Clamp Cover with 16mm diameter cable entry. Designed to protect alternator and electrical system from short and reduce battery terminal corrosion. Manufactured from 90° rated, high temperature poly vinyl chloride.



813213 Terminal Cover Red Straight

Red Straight Clamp Cover with 16mm diameter cable entry. Designed to protect alternator and electrical system from short and reduce battery terminal corrosion. Manufactured from 90° rated, high temperature poly vinyl chloride.

BATTERY ISOLATOR



Part No./ Description

814010 Solenoid Isolator 12 Volt Only

SPECIFICATIONS

VOLTAGE	12V only
CHARGING CURR	85A/150A peak
CHARGE TYPE	Parallel
CONTROL	Ignition
MOUNTING	Surface/firewall
CURRENT DRAW	780mA when charging
VOLTAGE DROP	None

Kit comprises

- Premium HD solenoid
- Surge protector
- 4m battery cable & 60cm aux battery earth cable
- Auxiliary battery terminals (pos & neg)
- Rocker switch, lugs, terminals, heat shrink & cable ties

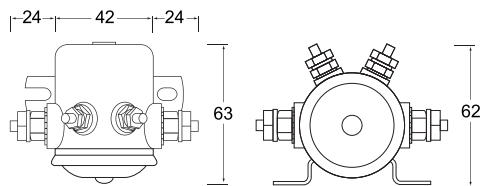

Part No./ Description

814011

12V 100A Electronic Isolator Kit

A fully automatic dual battery kit suitable for any mid-sized vehicle with an auxiliary battery.

Part No./ Description

814012

12V 150A Electronic Isolator Kit

A fully automatic dual battery kit ideal for use on large 4WD vehicles wishing to run double or triple battery systems.

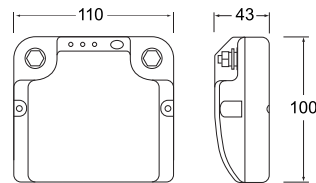

SPECIFICATIONS

VOLTAGE	12V	
CHARGING CURR	75A/100A peak	125A/150A peak
CHARGE TYPE	Parallel	
CONTROL	Electronic	
MOUNTING	Surface/firewall/battery side	
CURRENT DRAW	Charging 500mA (Standby 30mA)	
VOLTAGE DROP	None	
SURGE PROTECTION	Built in	
APPROVALS	E.C.	

LED CHARGE INDICATION

	ON	FLASH
RED LIGHT	Power on	auxiliary battery fault
BLUE LIGHT	Charging	over-current
BLUE LIGHT	Charging	over-current

Kit comprises

- Electronic isolator (100A) (150A)
- 6m cable & 60cm aux earth cable, auxiliary battery terminal, fuses, lugs, heat shrink & cable ties



Part No./ Description

814110 12V Surge Protector and Battery Analyzer

- Protects vehicle electronics against a voltage spike when jump starting
- Indicates battery condition and verifies that the alternator is charging while the motor is running
- Mounts to battery for permanent surge protection
- Quick and easy to fit



Part No./ Description

814112 12V/24V "Spikeguard" Surge Protectors

- Protects vehicle electronics against a voltage spike when jump starting
- Correct connection LED indicator
- LED battery level indicator
- Suits cable 10mm (8 B&S) to 70mm (00 B&S)
- Quick and easy to fit
- Rugged rubber housing



Part No./ Description

814113 12V/24V "Spikeguard" Service Mate

- Allows all methods of electric welding to be done on a vehicle while the battery is still connected. Ideal for all panels beaters and mechanics
- Correct connection LED indicator
- LED battery level indicator
- Rugged rubber housing